

phaze

A U D I O

**MUSIC
MATTERS**

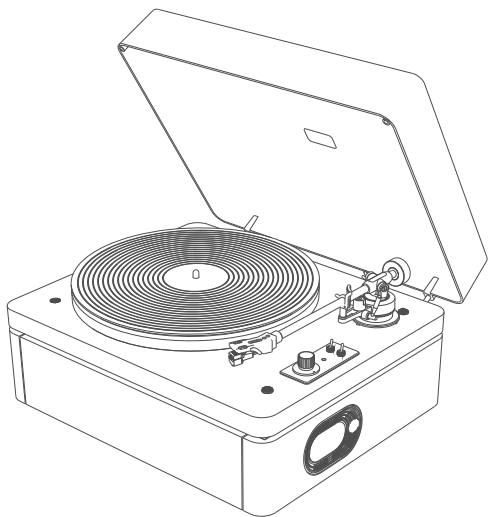

PHAZE AUDIO ADELLE

User Manual

Contents

1.Included Items	019
2.Component Diagram	020
3.Installation	021
4.Vinyl Playback	024
5.Bluetooth Playback	026
6.Connecting External Audio via RCA	027
7.Maintenance	028
8.Technical Specifications	030
9.Troubleshooting Guide	031
10.Safety Instructions	033

Included Items

Before installation, ensure all components listed below are included and undamaged. Retain the original packaging for potential returns.

- | | | |
|------------------|------------------------------|--|
| 1 Turntable Unit | 6 Sub-Platter | 11 User Manual |
| 2 Power Adapter | 7 Drive Belt | 12 Ceramic Flathead Screwdriver (for speed adjustment) |
| 3 Dust Cover | 8 Counterweight | 13 Metal Phillips Screwdriver (for adjusting counterweigh tightness) |
| 4 Anti-Slip Mat | 9 Cartridge Alignment Card | |
| 5 Platter | 10 Large-Hole Record Adapter | |

Note: The cartridge alignment and anti-skate control components have been pre-adjusted to optimal settings at the factory. No further adjustment is required.

Component Diagram

Components Names

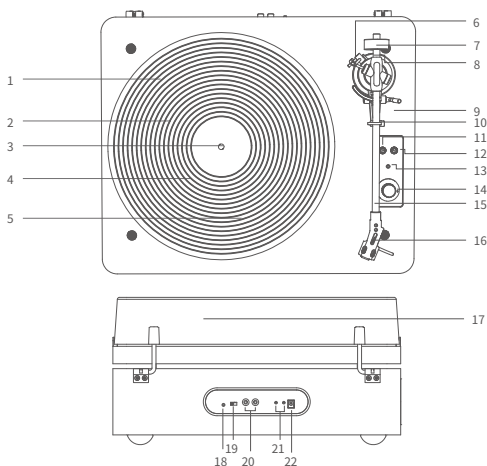

- | | | |
|------------------------|------------------------|---------------------------|
| 1 Motor Pulley | 9 Tonearm Lift Lever | 17 Dust Cover |
| 2 Drive Belt | 10 Tonearm Lock | 18 Ground Connector |
| 3 Turntable Spindle | 11 Function Switch | 19 Output Mode Switch |
| 4 Sub-Platter | 12 Speed Selector | 20 RCA Audio Output Ports |
| 5 Platter | 13 Indicator Light | 21 Speed Fine Adjustment |
| 6 Anti-skate Component | 14 Volume & Power Knob | 22 DC Input Jack |
| 7 Counterweight | 15 Tonearm | |
| 8 Balance Bar | 16 Cartridge | |

Installation

1. Before Installation

Remove the four cartridge damping pads, anti-skate component protective pads, stylus protector, and other components.

Tip: Keep all removed components for future shipment and use.

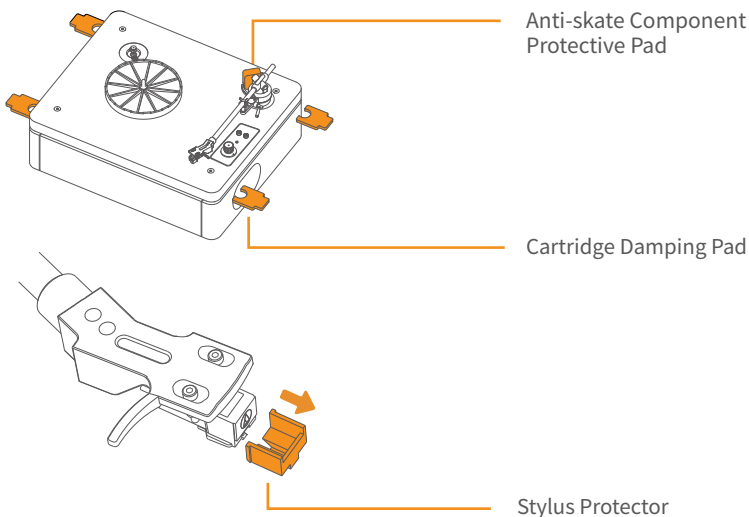

Important: When removing the stylus protector, ensure the stylus (needle) is not accidentally detached. If the stylus is removed, refer to the "Maintenance – Stylus Replacement" section for reinstallation instructions.

2. Installing the Platter

Follow the diagram to install the drive belt, platter, and anti-slip mat in sequence.

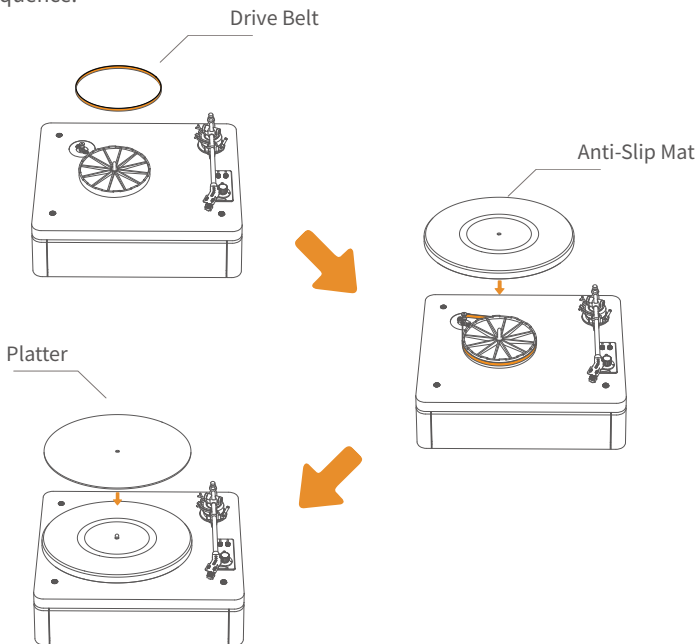

Note: Ensure the belt is not twisted during installation. After attaching, rotate the platter 10 times to verify smooth operation.

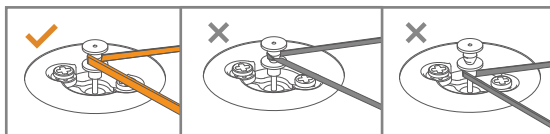

3. Installing the Counterweight

Attach the counterweight to the tonearm end, aligning the triangular arrow downward to the 2.5g marking.

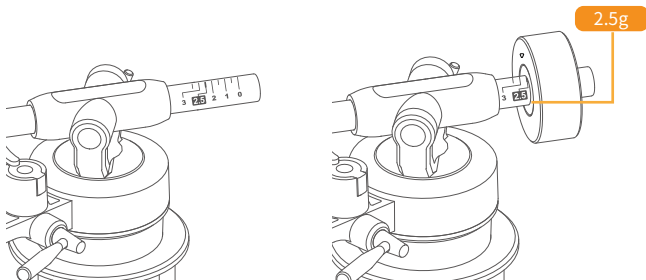

Caution: Do not confuse the counterweight with the large-hole adapter.

4. Placement

Place the turntable on a stable surface. Keep it away from speakers, radios or devices that emit strong radio waves (such as smartphones) to avoid the influence of vibration and sound pressure, as well as noise.

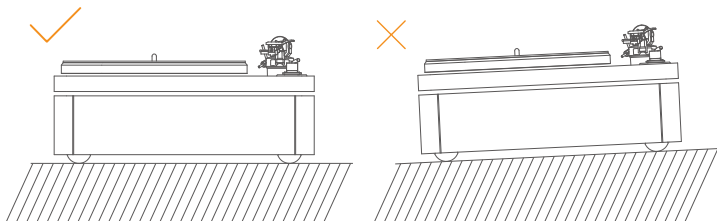

Vinyl Playback

Playing Records

1. Connect Power

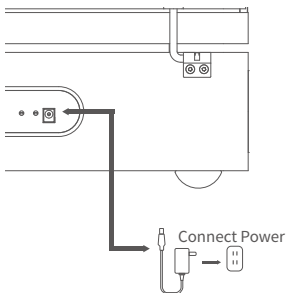

2. Place the Record



3. Control Operations

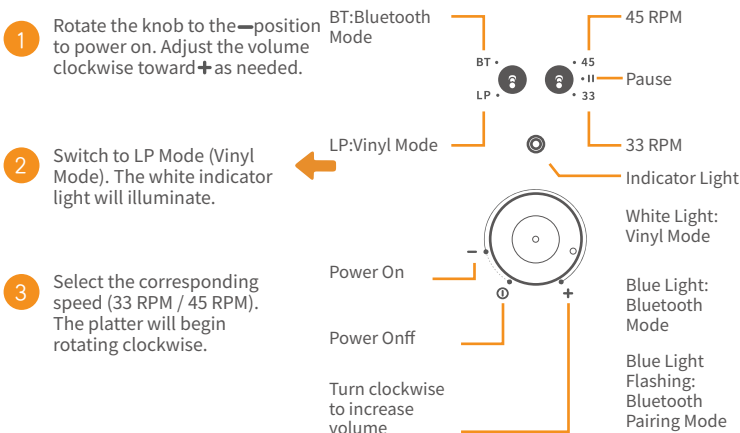

4. Playing a Record

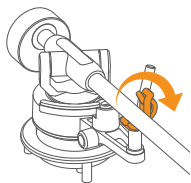

1

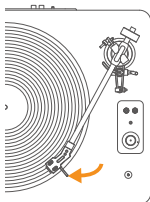

2

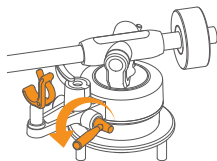

3

Release the tonearm lock;
Hold the stylus handle and move the stylus to the outer edge of the record;
Press the lift lever to the horizontal position gently to allow the stylus to slowly land on the record, and the record will start playing.

5. Turntable Reset

Lift the Tonearm: Raise the lift lever first when resetting.
Return the Tonearm: Move the tonearm back to its locked position and secure the lock.
Power Off: Turn the knob to the OFF position. ①
Store the Record: Remove the record and place it back into its protective sleeve.
Cover the Turntable: Close the dust cover securely.

Important Tips

- 1.The correct speed setting (33 RPM or 45 RPM) is typically printed on the record sleeve or inner label.
- 2.Clean the anti-slip mat regularly to prevent dust buildup, which may scratch records.
- 3.The platter will automatically stop rotating 3 minutes after playback ends.
- 4.Always lift the tonearm before resetting to avoid accidental stylus damage.
- 5.Ensure the tonearm is locked after use to prevent mechanical issues.
- 6.Store records vertically in their sleeves to avoid warping or scratches.
- 7.Disconnect the power adapter if the turntable will not be used for an extended period.

Bluetooth Playback

1. Activate Bluetooth Mode:

- Set the function switch to BT (Bluetooth Mode).
- The indicator light will glow blue and flash rapidly.

2. Pairing Process:

- Enable Bluetooth on your media device and search for **“ADELLE”**.
- Select the device to initiate pairing.

3. Connection Confirmation:

- Once paired, the blue indicator light will remain steadily lit.

4. Playback Control:

- Play music from another media device through the turntable.
- Adjust the volume by rotating the knob clockwise as needed.

Note: Bluetooth Version 5.3

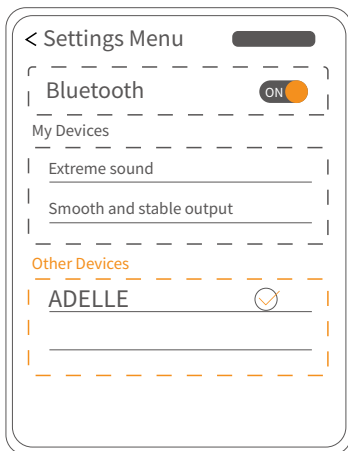

Connecting External Audio via RCA

This product includes built-in speakers and a built-in signal amplifier. To use your own amplifier or audio system, follow the instructions below:

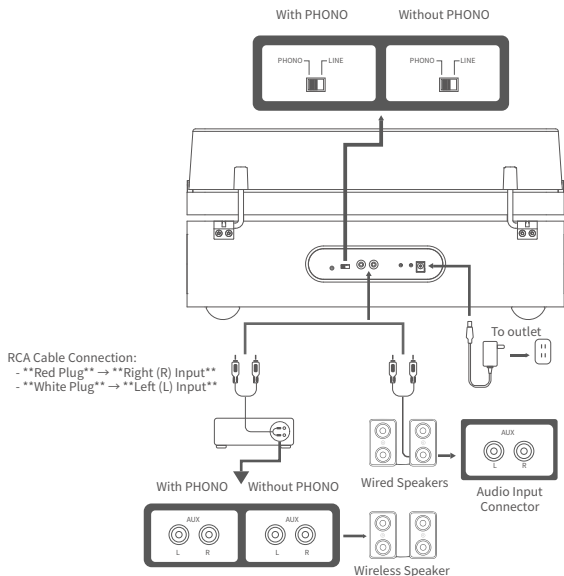

Important Notes

1. Built-In Speakers:

- The built-in speakers will remain active when using external devices. To route audio exclusively through your external system, turn the turntable's volume knob to the minimum position —.

2. Passive Speakers:

- The RCA output does not support passive speakers directly. Use an external amplifier if connecting passive speakers.

Maintenance

1. Cleaning the Turntable Body

- When to Clean: If the turntable body is dirty or dusty
- Procedure:
 - ① Disconnect the AC adapter.
 - ② Wipe the surface gently with a soft, dry cloth.

2. Cleaning the Stylus

- When to Clean: If the stylus accumulates dust or debris.
- Procedure:
 - Use a stylus-specific cleaner (not included with the product).

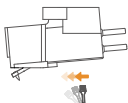

Proper Operation ✓



Improper Operation ✗

3. Replacing the Stylus

- *Recommended replacement interval: Every 400 hours of use.*
- Removing the Stylus
 - ① Grip Firmly: Hold the cartridge head and cartridge body securely
 - ② Apply Force: Gently pull the stylus downward and forward to detach it.

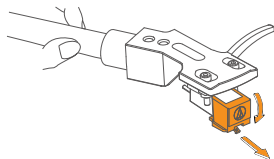

4. Installing a New Stylus

- Align the Base: Insert the stylus base into the slot at the end of the cartridge.
- Secure in Place: Push the stylus upward until you hear a click.

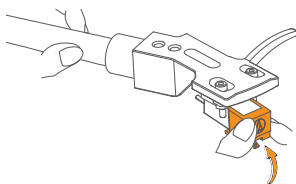
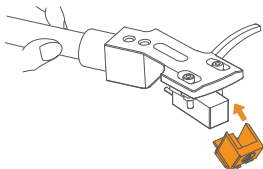

- Ensure No Gap Between Stylus and Cartridge

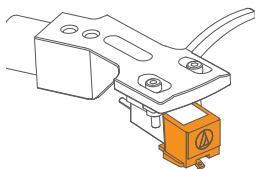

Correct Installation

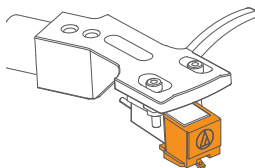

Incorrect Installation

Adjustment Instructions

This unit is equipped with two screwdrivers for technical adjustments. Under normal circumstances, no adjustments are necessary.

Counterweight Tightness Adjustment

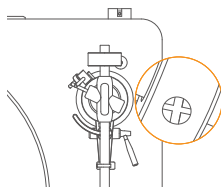

Anti-Skate Control Adjustment

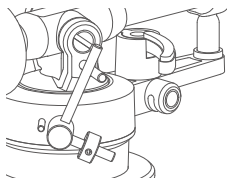

Speed Fine-Tuning

- 33 +



- 45 +



Technical Specifications

Turntable

Parameter	Specification
Power Adapter	15V \equiv 2000MA
Maximum Power Consumption	30W
Speeds	33 1/3 RPM, 45 RPM
Amplifier (RMS)	12W \times 2 (Bluetooth Mode), 12W \times 2 (Phono Mode)
Dimensions (L \times W \times H)	420 \times 344 \times 210 mm
Net Weight	10.2Kg

Cartridge

Parameter	Specification
Model	Audio-Technica AT3600L
Frequency Response	20Hz–20kHz
Channel Balance	20 dB (1 kHz) / 15 dB (10 kHz)
Channel Separation	Within 1.5 dB
Output Voltage	4.2mV (1 kHz, 5 cm/sec)
Recommended Load Resistance	47 k Ω
Amplifier Connection	MM (Moving Magnet)-input
Recommended Tracking Force	2.5 \pm 0.5 g
Weight	0.18 oz (5.1 g)

Note: Design and specifications are subject to change without notice.

Troubleshooting Guide

Issue	Solutions
Platter Not Spinning	<ul style="list-style-type: none"> • Is the power adapter connected to the outlet? <ul style="list-style-type: none"> - Ensure the power adapter is securely plugged into a functional power outlet. • Is the speed selector in the Pause position? • Indicator Light Status <ul style="list-style-type: none"> - Light Off: Follow the correct startup procedure: <ol style="list-style-type: none"> 1. Turn on the power switch. 2. Select the appropriate speed (33 RPM/45 RPM). 3. Start the platter. - Blue Light: The turntable is in Bluetooth mode. Switch the function selector to LP Mode. • Is the drive belt detached or damaged? <ul style="list-style-type: none"> - Inspect the belt and reinstall it properly. Replace if worn or broken. • Does the motor work? <ul style="list-style-type: none"> - If assembly and operation are correct, check if the motor pulley rotates. • If the machine enters sleep mode if the standby time is too long? <ul style="list-style-type: none"> - Disconnect the power (unplug the adapter to fully power cycle the unit).
Platter Spins But No Sound/Low Volume	<ul style="list-style-type: none"> • Are the wiring connections and function settings incorrect? <ul style="list-style-type: none"> - Ensure the PHONO/LINE switch matches the input type of your connected audio device. - Verify all audio cables are securely connected and device settings (e.g., volume) are correct. • Does the stylus damage? <ul style="list-style-type: none"> - Replace the stylus if worn. *Recommended replacement interval: 400 hours.* • Is the stylus properly seated on the cartridge? <ul style="list-style-type: none"> - Reinstall it correctly. • If the machine enters sleep mode if the standby time is too long? <ul style="list-style-type: none"> - Disconnect the power (unplug the adapter to fully power cycle the unit).
Skipping During Playback	<ul style="list-style-type: none"> • Is the record warped? <ul style="list-style-type: none"> - Inspect for bends. • Does the record have scratches? <ul style="list-style-type: none"> - Clean or replace it. • Is the tracking force calibrated? <ul style="list-style-type: none"> - Adjust it via the "Cartridge Setup" section in the manual. • Does the stylus damage? <ul style="list-style-type: none"> - Replace the stylus if worn. *Recommended replacement interval: 400 hours.*

Unusual Humming Noise	<ul style="list-style-type: none"> • Is the turntable absorbing vibrations from the floor, walls, or nearby speakers? <ul style="list-style-type: none"> - Reduce environmental vibrations or install the turntable on a vibration-resistant surface. • Is the turntable placed on an unstable surface? <ul style="list-style-type: none"> - Clean the stylus with a professional brush.
Audible Noise During Playback	<ul style="list-style-type: none"> • Is there dust buildup on the stylus tip? <ul style="list-style-type: none"> - Clean the stylus with a professional brush. • Does the vinyl record have dust or scratches? <ul style="list-style-type: none"> - Clean the record surface with a commercial vinyl cleaner or replace the record. • Is the tracking force incorrect? <ul style="list-style-type: none"> - Adjust the tracking force according to the "Cartridge Setup" section in the manual.
Slow or Inconsistent Speed	<ul style="list-style-type: none"> • Is the drive belt installed correctly? <ul style="list-style-type: none"> - Reinstall the belt as described in the "Belt Installation" section of the manual. • Is the belt overstretched? <ul style="list-style-type: none"> - Replace the belt with a new one.
Incorrect Playback Speed	<ul style="list-style-type: none"> • Is the speed setting (33 RPM/45 RPM) correct for the record type? <ul style="list-style-type: none"> - Select the appropriate speed based on the record label. • If the speed remains abnormal? <ul style="list-style-type: none"> - Adjust the speed fine-tuning screw on the rear panel.
Tonearm Fails to Auto-Play/Return	<ul style="list-style-type: none"> • Does the tonearm fail to Auto-Play/Return? <ul style="list-style-type: none"> - This turntable is not fully automatic. Manually position the tonearm over the record and return it to the rest after playback.
Stylus Fails to Contact Record	<ul style="list-style-type: none"> • Does the stylus fail to contact record? <ul style="list-style-type: none"> - Check if the tonearm lift lever is lowered. If stuck, manually raise and lower the lever 10 times to redistribute internal lubricant, then retry.

Safety Instructions

- 1. Read the Manual:** Operate this product strictly in accordance with the user manual.
- 2. Avoid Moisture:** Do not expose the product to rain, moisture, or water splashes.
- 3. Voltage Compliance:** Ensure the power supply voltage matches the voltage specified on the product label.
- 4. Plug Safety:** Do not modify the plug in any way.
- 5. Power Cord Care:** Avoid pulling, bending, stepping on, or crushing the power cord.
- 6. Proper Assembly:** Assemble the product as instructed. Do not place objects on the turntable.
- 7. Foreign Objects:** Prevent liquids or objects from entering the unit, as they may cause electric shock, short circuits, or fire hazards.
- 8. No Self-Repairs:** Do not attempt to disassemble or repair the turntable yourself. All repairs must be performed by qualified technicians.
- 9. Authorized Parts:** Use only manufacturer-approved replacement parts or accessories.
- 10. Heat Sources:** Keep the product away from high-temperature environments or open flames.
- 11. Stable Placement:** Place the turntable on a flat, stable surface. Handle with care during movement to prevent tipping or damage.
- 12. Ventilation:** The slots and openings on the unit are designed for ventilation. Do not block or cover them to avoid overheating.
- 13. Power Disconnection:** Unplug the power cord during thunderstorms or extended periods of non-use.



phaze
A U D I O

**MUSIC
MATTERS**

phazeaudio.com